

1046 MONOLIFT – FIELD COUNTERWEIGHT INSTALLATION INSTRUCTIONS

1046 MONOLIFT - COUNTERWEIGHT DETAIL 1-ASSY DETAIL BREAKOUT

1. FOR THE FOLLOWING SHEETS, USE THIS BREAK OUT DRAWING FOR PART NAMES AND IDENTIFICATION

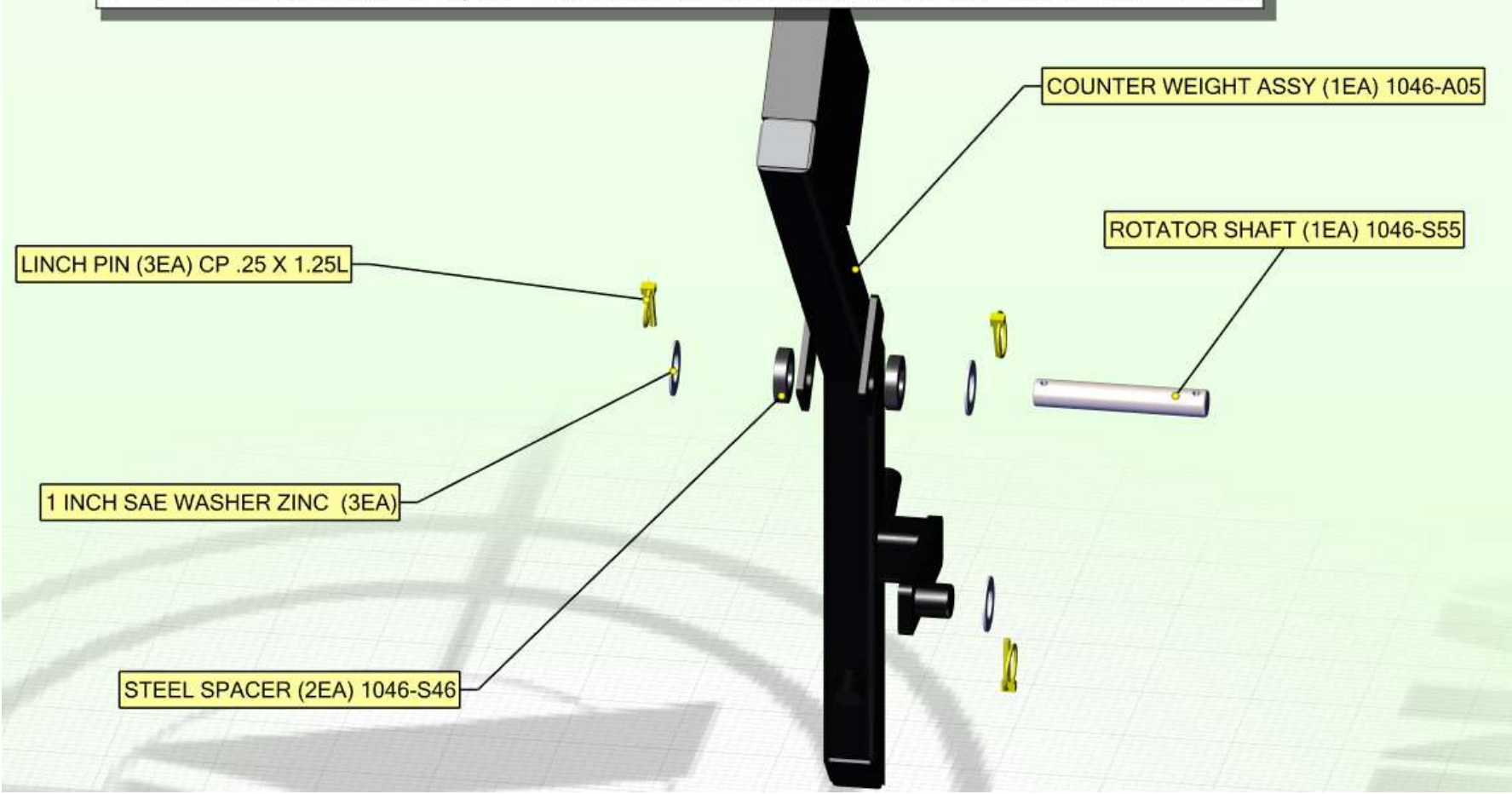

1046 MONOLIFT – FIELD COUNTERWEIGHT INSTALLATION INSTRUCTIONS

1046 MONOLIFT - FIELD COUNTERWEIGHT ASSY OP 1 - REMOVE INTERFERANCE-POSITION COUNTER WEIGHT FOR ASSY

1. REMOVE LOWER COUNTERWEIGHT CATCH BRACKET AND SET ASIDE.
2. POSITION COUNTERWEIGHT ASSY AS SHOWN RESTING ON COUNTWEIGHT STOP PAD.



****CAUTION****
THESE ASSEMBLY STEPS REQUIRE A
MINIMUM OF (2) PERSONNEL. (1) TO HOLD
THE COUNTERWEIGHT ASSEMBLY IN PLACE
WHILE THE OTHER ASSEMBLES FASTENERS.
FAILURE TO USE (2) PERSONNEL CAN RESULT
IN BODILY INJURY OR EQUIPMENT DAMAGE..

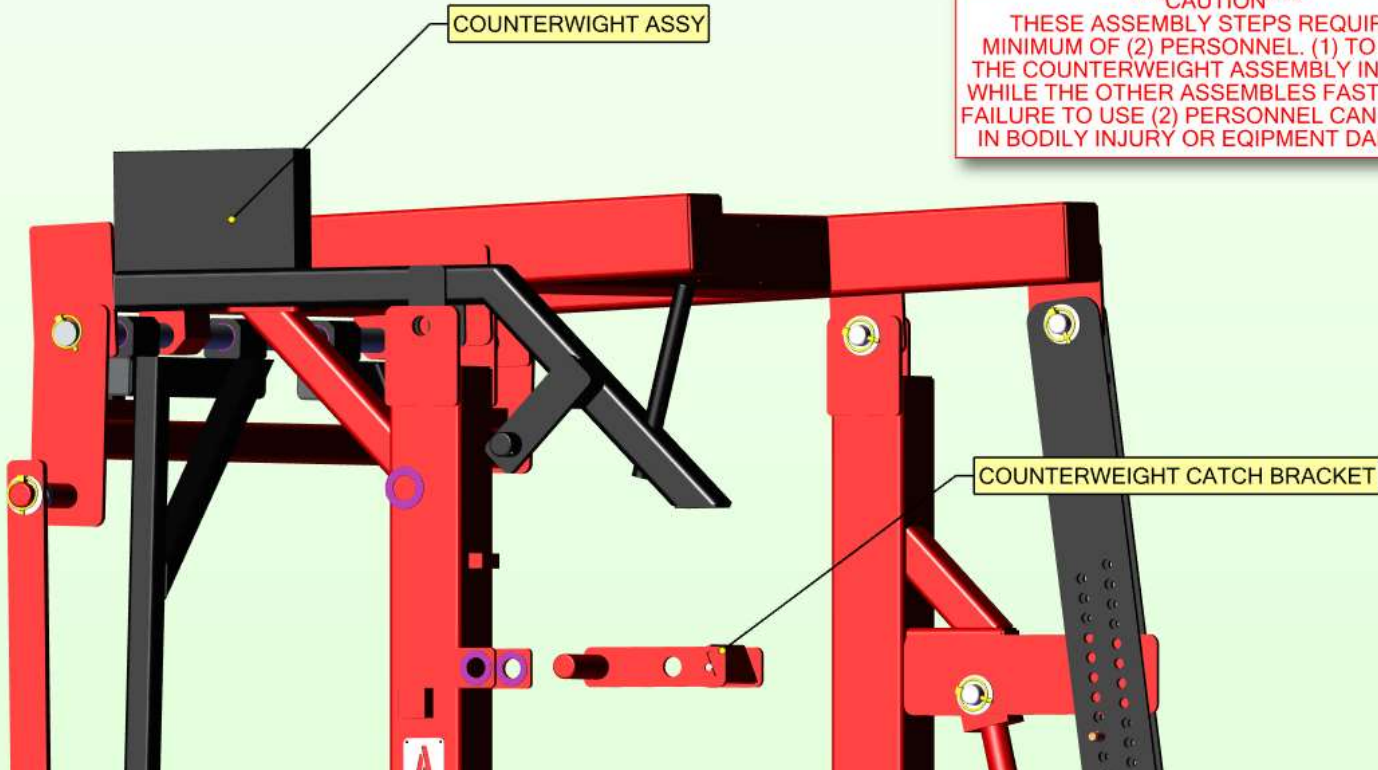

1046 MONOLIFT – FIELD COUNTERWEIGHT INSTALLATION INSTRUCTIONS

1046 MONOLIFT - FIELD COUNTERWEIGHT ASSY OP2 - INSTALL ROTATOR SHAFT

1. WITH THE COUNTERWEIGHT RESTING ON THE STOP PAD, ALIGN THE ROTATOR SHAFT HOLE IN THE COUNTERWEIGHT ASSY WITH THE FRAME
2. PASSING THE ROTATOR SHAFT FROM THE INSIDE, THRU THE UPPER SWING FRAME HOLE, MAIN FRAME HOLE, THRU (1) STEEL SPACER, THEN THRU HOLE IN THE COUNTER WEIGHT ASSY, THE (2ND) STEEL SPACER, AND FINALLY THE OUTSIDE OF THE MAIN FRAME. SECURE WITH (1EA) WASHER(S) ON BOTH OUTSIDS OF FRAME AND (2) LINCH PINS.

NOTE: STEEL SPACERS GO ON BOTH SIDES OF THE COUNTERWEIGHT ASSY, HOWEVER, INSIDE THE FRAME MOUNTS. SEE FINAL ASSY DETAILS FOR MORE DETAIL PICTURES.

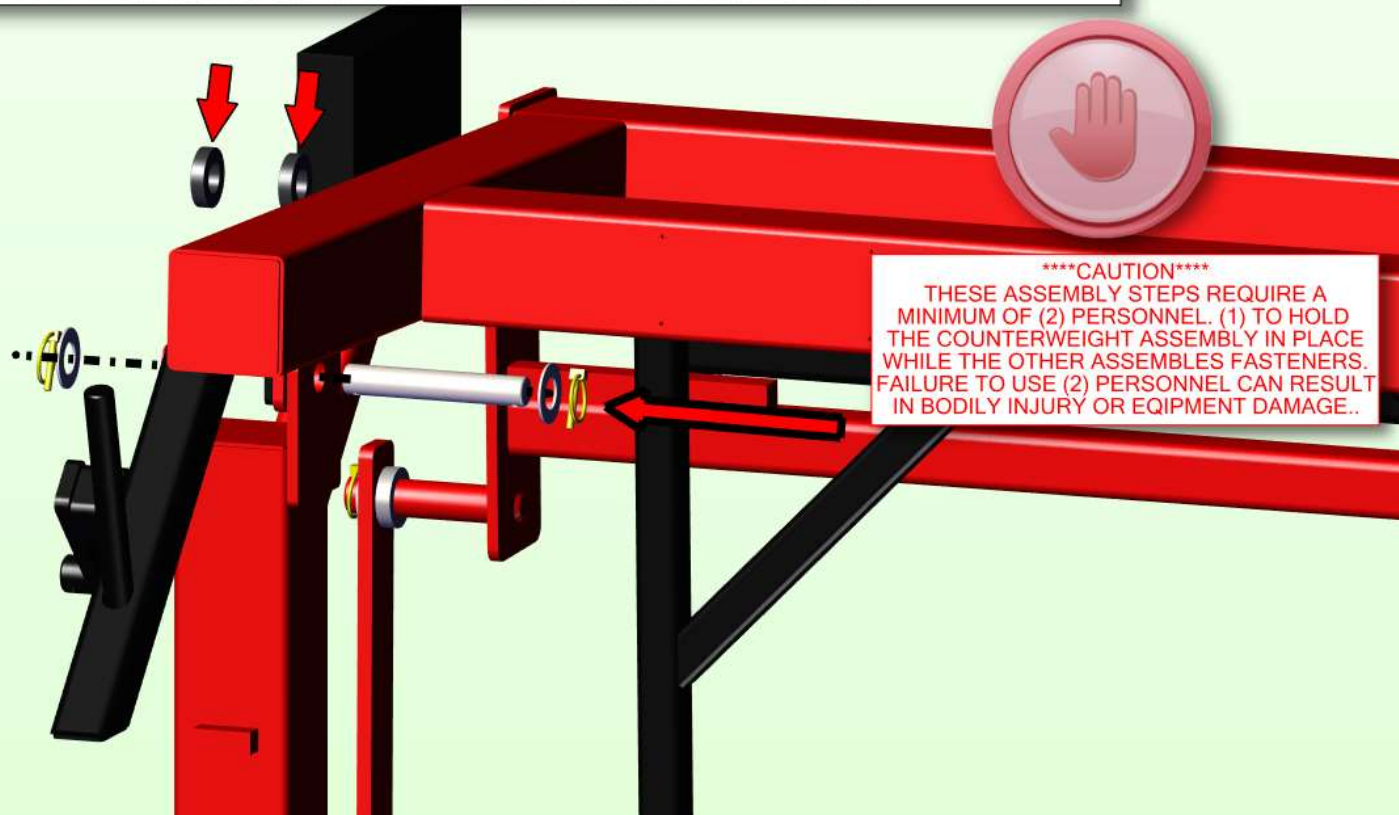

1046 MONOLIFT – FIELD COUNTERWEIGHT INSTALLATION INSTRUCTIONS

1046 MONOLIFT - FIELD COUNTERWEIGHT ASSY OP3 - INSTALL STOP-CATCH BRACKET & PIN

1. RAISE THE COUNTERWEIGHT UNTIL IT COMES TO REST ON THE FRAME. INSTALL THE STOP CATCH BRACKET WITH THE STOP PIN, PIN BEHIND BEVEL ANGLE ON COUNTERWEIGHT FRAME, ENSURING A PLASTIC SPACER IS BETWEEN THE LOWER LEG FRAME COUNTERWEIGHT ASSY AND THE FRAME. ALIGN ALL HOLES AND PASS PIN THROUGH FRAME, PLASTIC SPACER, COUNTERWEIGHT LEG, PLASTIC SPACER AND FINALLY THE OTHER FRAME HOLE. SECURE WITH A WASHER ON BOTH OUTSIDES, AND (2) LINCH PINS.



1046 MONOLIFT – FIELD COUNTERWEIGHT INSTALLATION INSTRUCTIONS

1046 MONOLIFT - FIELD COUNTERWEIGHT ASSY OP4 - INSTALL THE FRONT JOINER BAR

1. ENSURE A PLASTIC SPACER IS ON THE PIN AS SHOWN. RAISE THE JOINER BAR AND ALIGN THE PIN WITH THE HOLE IN THE JOINER BAR. SECURE WITH WASHER AND LINCH PIN.

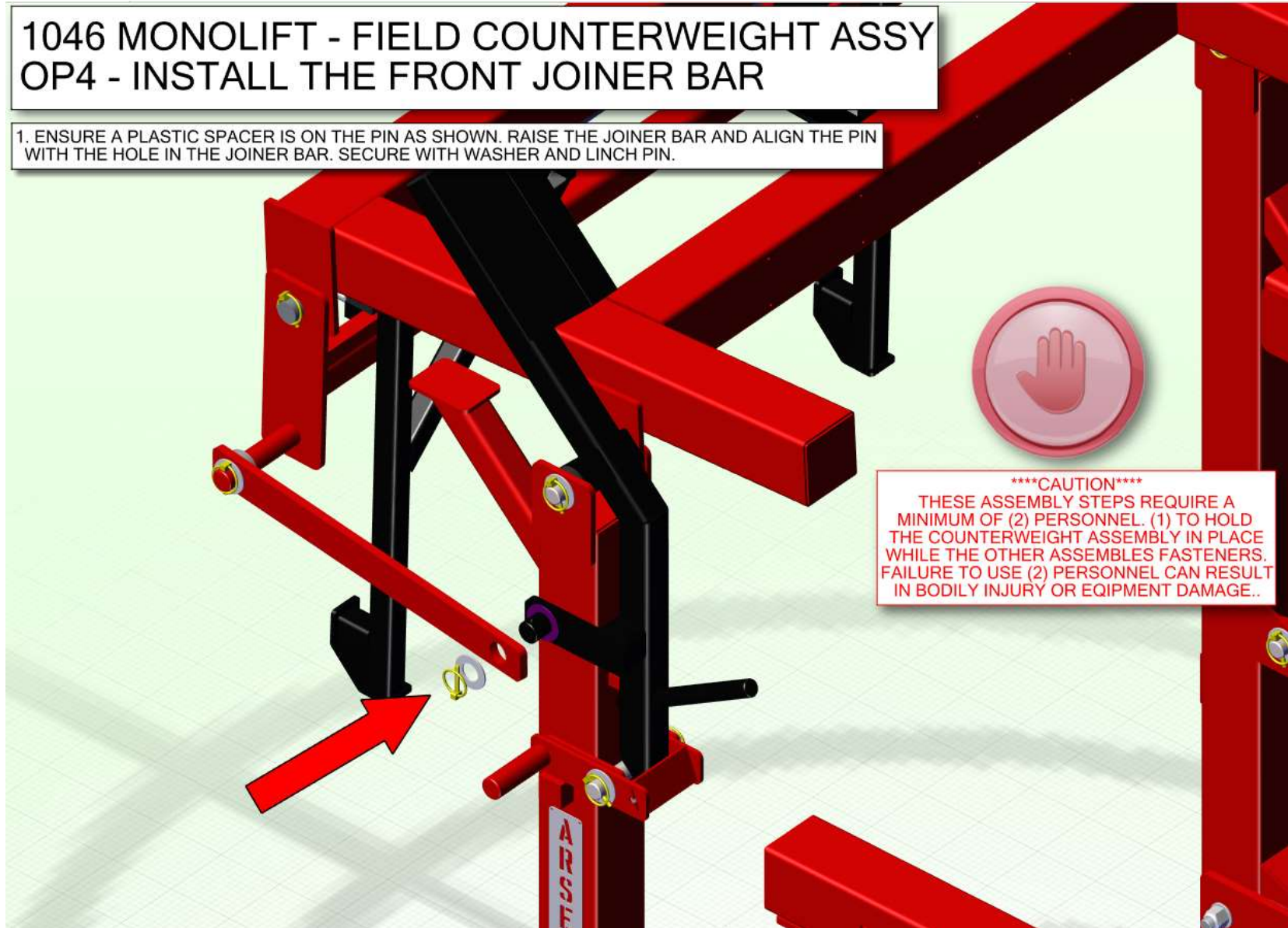

****CAUTION****
THESE ASSEMBLY STEPS REQUIRE A
MINIMUM OF (2) PERSONNEL. (1) TO HOLD
THE COUNTERWEIGHT ASSEMBLY IN PLACE
WHILE THE OTHER ASSEMBLES FASTENERS.
FAILURE TO USE (2) PERSONNEL CAN RESULT
IN BODILY INJURY OR EQUIPMENT DAMAGE..

1046 MONOLIFT – FIELD COUNTERWEIGHT INSTALLATION INSTRUCTIONS

1046 MONOLIFT - COUNTER WEIGHT DETAIL 2- FINAL ASSY DETAIL

1. THIS DETAIL BREAKOUT DRAWING IS TO AID IN THE ARRANGMENT AND STACK-UP OF THE COUNTERWEIGHT MECHANICAL JOINTS.

